

In this Newsletter:

NICEE Activities

1. Open House of NICEE
2. Inter-School Quiz Competition on IITK-BMTPC Earthquake Tips 2016-17
3. Literature Review Workshop for Post Graduate Students
4. Workshop for Under Graduate Architecture Students in Third Year
5. Intimation Regarding Change of Postal Address/ email id
6. SAP/ETABS Software Distribution for Institutes
7. RESIST Software Available for Individual Users
8. EERI e-affiliate Membership
9. Calendar of Events

Conferences

10. 16th World Conference on Earthquake Engineering, January 09-13, 2017, Santiago, Chile

Excerpts from other Newsletters

11. Newsletter of Earthquake Engineering Research Institute (EERI), USA
12. Earthquake Hazard Centre Newsletter

Support to NICEE

13. Recent Donors to NICEE

Details:

1. Open House of NICEE



The annual Earthquake Engineering Open House of NICEE is scheduled to be held at IIT Kanpur during Nov 03 – 12, 2016. The open house is held with the aim to enable postgraduate students to conduct literature survey for their thesis related to earthquake engineering issues and interact with the faculty and professionals. The Open House also welcomes professional engineers and architects to help them

familiarize themselves with enormous literature available at NICEE on design and construction of safe habitat. For further details or any queries please contact : Suresh Ailawadi at Tele - 0512 - 259 7749, Fax - 0512 - 259 7794 or E-mail: asuresh@iitk.ac.in

2. Inter-School Quiz Competition based on IITK-BMTPC Earthquake Tips 2016-17



Enthused by the success of the Inter School Quiz Competition based on IITK-BMTPC Earthquake Tips for the last seven years, invitations letters have been sent to schools for the participation in the quiz during 2016-17. For further details please visit <http://www.nicee.org/Quiz/quiz.htm> . Members willing to enthuse and/ or conduct the preliminary

round of quiz in their city of residence may please contact: Suresh Ailawadi at Tele - 0512 - 259 7749, Fax - 0512 - 259 7794 or E-mail: asuresh@iitk.ac.in

3. Literature Review Workshop for Post Graduate Students

The Annual Workshop for post graduate students pursuing their masters or doctorate degree with thesis in earthquake engineering is scheduled to be held during June 01-10, 2017 at IIT Kanpur. The aim of this workshop was to provide an access to the students to quality research material so that they can do a thorough literature review for their thesis. For details about previous workshops please visit http://www.nicee.org/MTech_Workshop/ . For further details or any queries please contact: Suresh Ailawadi at Tele - 0512 - 259 7749, Fax - 0512 - 259 7794 or E-mail: asuresh@iitk.ac.in

4. Workshop for Under Graduate Architecture Students in Third Year

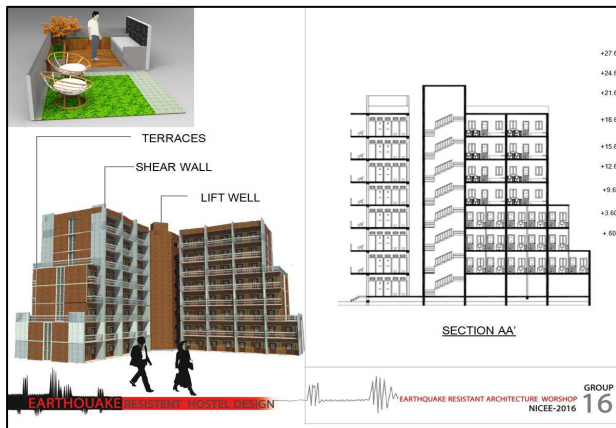

A workshop for Architecture students is scheduled to be held at IIT Kanpur during June 2017, the firm date of the same will be announced shortly. The aim of this workshop is to draw the attention of Architecture students towards keeping the earthquake engineering aspects in view while designing their structures. For details about previous workshops please visit

http://www.nicee.org/Architecture_Workshop/ . For further details or any queries please contact: Suresh Ailawadi at Tele - 0512 - 259 7749, Fax - 0512 - 259 7794 or E-mail: asuresh@iitk.ac.in

5. Intimation Regarding Change of Postal Address/ email id



It gives me great pleasure to inform you that we currently more than 14,100 subscribers on NICEE list. At times we face problem of our mails being blocked by the outside servers with the presumption that we are spamming.

We would therefore like to request you to please do inform us as and when you switch over from one email id to another. We will stop

sending mails to your old email id and will subscribe your current email id to nicee-list so that you continue to receive communication from NICEE.

Similarly, it is our earnest request that please do let us know whenever you want us to change your postal address and we will update our records. You may please inform us by sending a mail to nicee@iitk.ac.in .

6. SAP/ETABS Software Distribution for Institutes

SAP/ETABS software is available for distribution from CSI Engineering Software Pvt. Ltd. for use in the institutes, free of cost, through NICEE. Processing fee of Rs. 20,000/- will be charged, hence forth, by NICEE for the purpose. For further details and downloading of application form please visit <http://www.nicee.org/npeee/CSIEducationalSoftware.pdf> . For individual requirements please contact CSI India directly at info@csiespl.com

7. RESIST Software Available for Individual Users

RESIST Software is now available for individual users. A copy of the same can be requested from NICEE on payment of Rs. 2,000/-. For further details please visit <http://www.nicee.org/npeee/showpage.php?id=149> and for any queries please contact: Suresh Ailawadi at Tele - 0512 - 259 7749, Fax - 0512 - 259 7794 or E-mail: asuresh@iitk.ac.in, nicee@iitk.ac.in

8. EERI e-affiliate Membership

EERI is offering e-affiliate membership. For further details regarding advantages and membership form, please visit http://www.nicee.org/eeri_affiliate/E-AffiliateBrochure.pdf . The membership form duly filled with membership fee of Rs. 1,800/- for the current year can be sent to NICEE. Filled forms can be scanned and sent to nicee@iitk.ac.in and payment made online at http://www.nicee.org/NICEE_donation.php choosing "EERI Membership" as the option. Existing members can renew their membership by paying online or through a cheque/ DD drawn in favour of "National Information Centre of Earthquake Engineering" payable at Kanpur. Existing members need to fill in the form again only if there is any change in the information given by them earlier.

9. Calendar of Events

Please visit <http://www.nicee.org/Calender.pdf> for latest update on world wide events related to Earthquake Engineering.

10. 16th World Conference on Earthquake Engineering, January 09-13, 2017, Santiago, Chile

16th World Conference on Earthquake Engineering is scheduled to be held during January 09-13, 2017 at Santiago, Chile. For further details please visit <http://16wcee.com/index.php>

11. Newsletter of Earthquake Engineering Research Institute (EERI), USA

The format of the *EERI Newsletter* has changed and it is now available bimonthly, called 'The Pulse'. The latest newsletter is available online at:

<https://www.eeri.org/cohost/member-resources/pulse> . The back issues can be viewed at <https://www.eeri.org/cohost/member-resources/pulse/archives>

Following are selected contents of the Newsletter:

- Call for Nominations for the 2017 Bruce Bolt Medal
- 2016 EERI Student Leadership Council: Retreat and Elections

Publications

- Earthquake Spectra: Preprint Manuscripts

12. Earthquake Hazard Centre Newsletter

The July 2016 issue of Earthquake Hazard Centre Newsletter of the School of Architecture, Victoria University of Wellington, New Zealand can be read or downloaded from <http://www.victoria.ac.nz/architecture/centres/earthquake-hazard-centre>.

The contents are as follows:

- Editorial
- Virtual site visit to RC frame infill buildings
- How safe is my house?
- Building damage, Kumamoto Earthquake, Japan
- Performance of RC frame structures with brick infill, Nepal

13. Recent Donors to NICEE

NICEE thanks the recent donors for their generous contribution:

Rs. 20,000/- to Rs. 99,999/-

S. H. Babu, Secunderabad

Rs. 4,000/- to Rs. 19,999/-

Ascent Consulting Engineers, Mumbai

Reci Engineering Private Limited, Mumbai

Vijay Pal Singh, Alwar

Rs. 3,999/- and below

Anjan Kumar Dutta, Kolkata

Benudhar Sarma, Assam

